

+

 $+$ 

### RIGHT ANGLE SECTION OF BARREL (STAGE I AND STAGE II)

(LOOKING DOWNSTREAM)  
THERE ARE 67 "C" BARS IN SECTION OF BARREL.

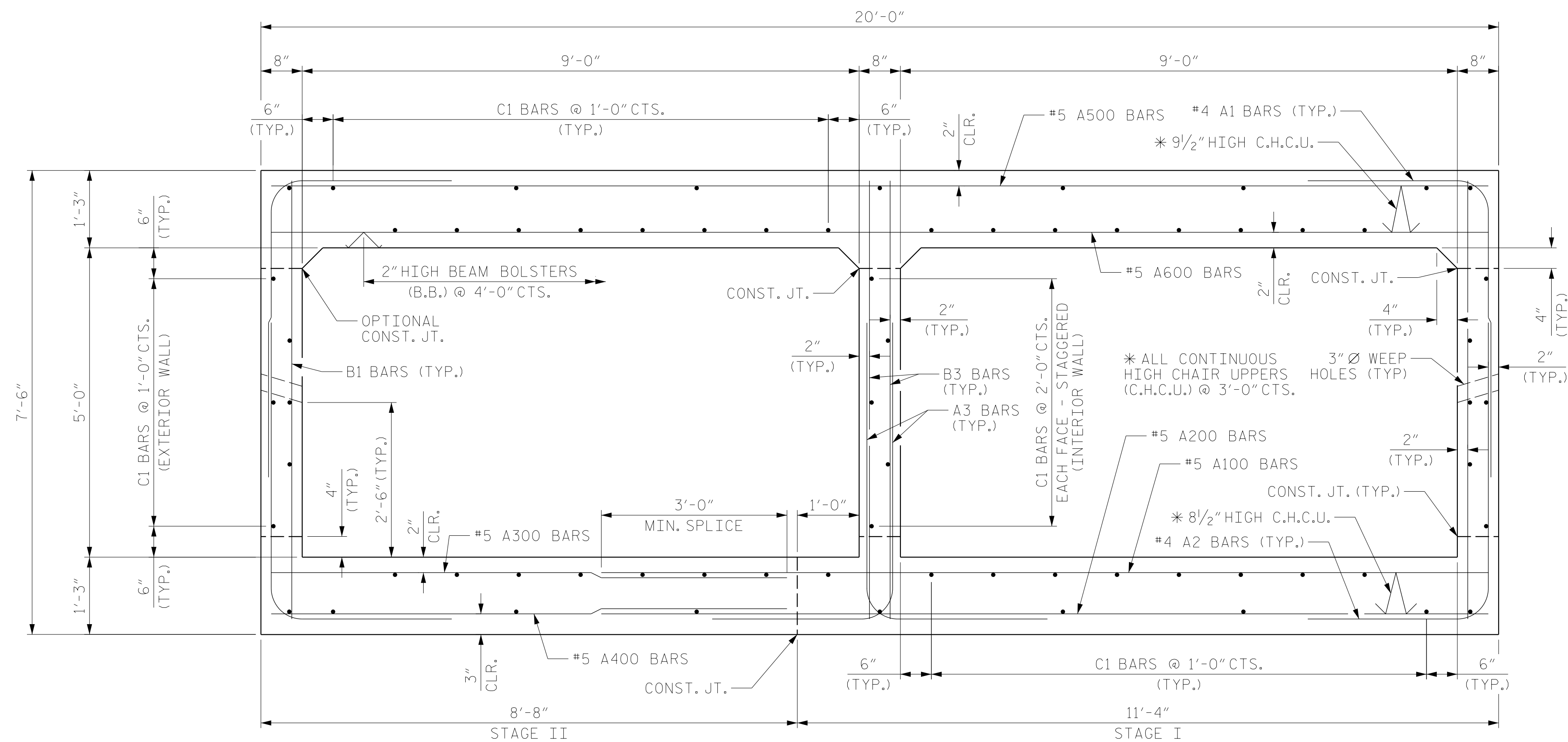
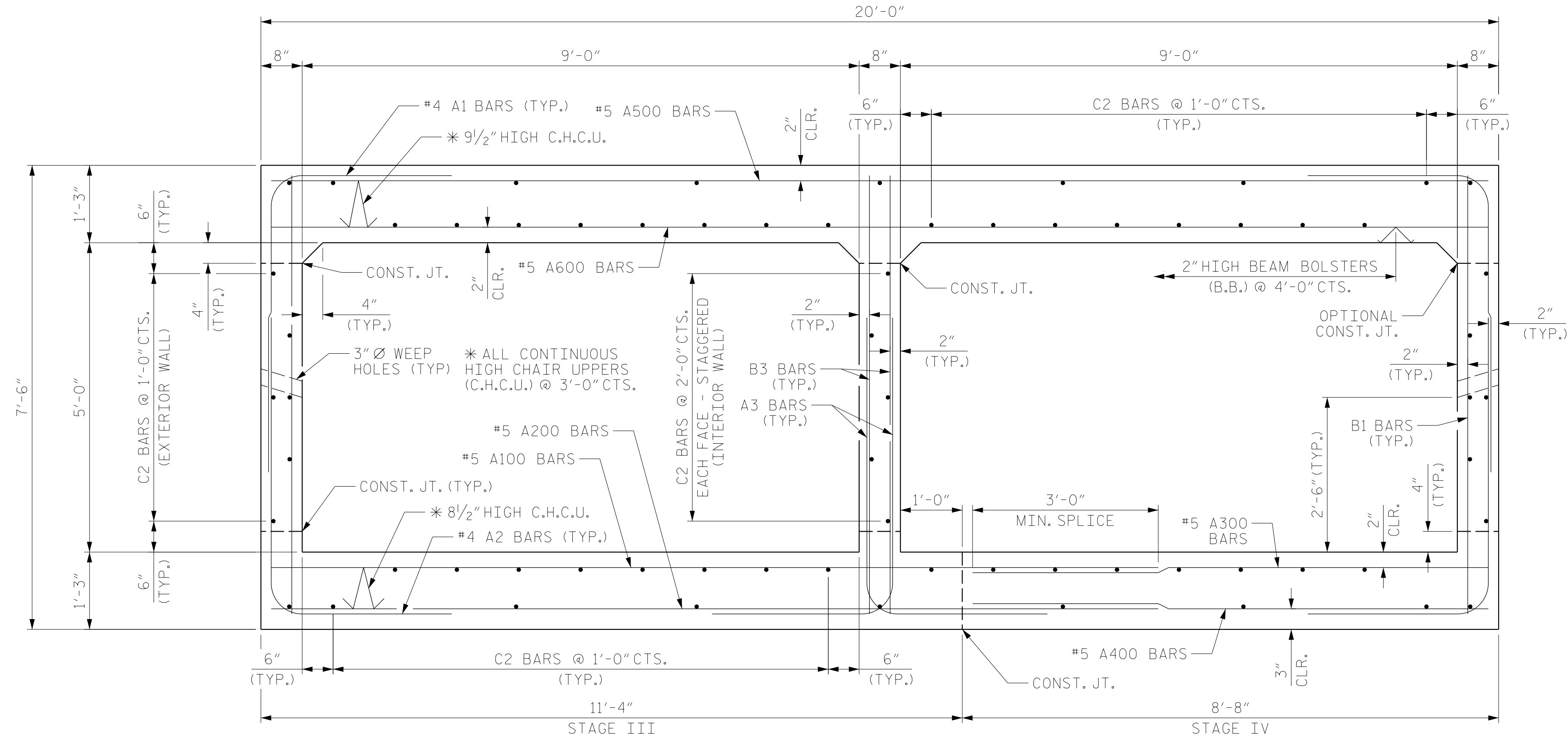

## RIGHT ANGLE SECTION OF BARREL (STAGE III AND STAGE IV)

(LOOKING DOWNSTREAM)  
THERE ARE 67 "C" BARS IN SECTION OF BARREL.

DRAWN BY : N. CUANY DATE : 02/2024  
 CHECKED BY : T. LAWS DATE : 02/2024  
 DESIGN ENGINEER OF RECORD: M. ACOSTA DATE : 08/2025

DOCUMENT NOT CONSIDERED  
FINAL UNLESS ALL  
SIGNATURES COMPLETED

NOTES:

THERE ARE 25 "C" BARS IN STAGE I  
AND STAGE III SECTION OF BARREL.

THERE ARE 42 "C" BARS IN STAGE II  
AND STAGE IV SECTION OF BARREL.

C1 BARS FROM STAGE I AND STAGE II  
TO EXTEND 2'-7" INTO STAGE III AND  
STAGE IV.

PROJECT NO. BP14.R002  
HAYWOOD COUNTY  
 STATION: 12+71.00 -L187-

SHEET 5 OF 10



STATE OF NORTH CAROLINA  
DEPARTMENT OF TRANSPORTATION  
RALEIGH

DOUBLE 9'-0" X 5'-0"  
CONCRETE BOX CULVERT  
BARREL

45° SKEW

REVISIONS						SHEET NO.  C1-5
NO.	BY:	DATE:	NO.	BY:	DATE:	
1			3			TOTAL SHEETS 10
2			4			